

## Tri-Tech Medical Inc.

## *E Z Backfeed™ Retro, E Z Find™ & E Z Feed™ Products*

Tri-Tech Medical patented E Z Backfeed™ Retro, E Z Find™ and E Z Feed™ products allow most existing medical gas valves to be converted to incorporate a DISS gas specific backfeeding port and a DISS gas specific transducer connection. The benefits provided are: the facility has available on line port(s) for backfeeding specific areas of the facility for emergency preparedness and for remodeling. Also, the transducers, which provide/monitor gas line pressures in the zone, are able to be installed in the corresponding zone valve box for easy access for testing and service.

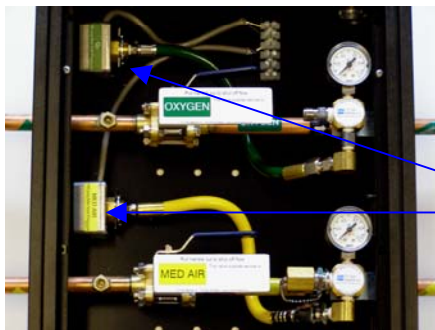

*Where would you prefer  
to have your alarm  
transducers installed?*

*Here  
or  
Here*



*Where would you  
prefer to backfeed  
your medical gases?*

*Here  
or  
Here*

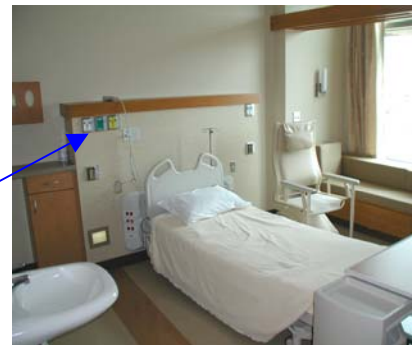

There is a need for an acceptable place to backfeed medical gases that is safe, easy to find, easy to access. There is a need for an acceptable place to install transducers that is safe to access, easy to find and easy to access. That is what the E Z Backfeed™, E Z Feed™, and E Z Find™ products are all about – making your hospital safer and your job and the verifier's job easier.

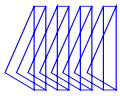

**Tri-Tech  
Medical Inc.**

*E Z Backfeed™ Retro,  
E Z Find™ & E Z Feed™ Products*



E Z Backfeed™ Retrofit Assembly

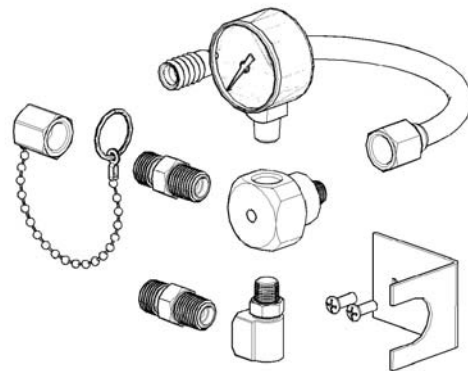

E Z Find™ Retrofit Assembly

***How to Order E Z Products:***

	<b>Oxygen</b>	<b>Med Air</b>	<b>N2O</b>	<b>CO2</b>	<b>N2</b>	<b>Med Vac</b>
<b>E Z Backfeed™ Retrofit Assemblies</b>	EZBACK-OXY	EZBACK-AIR	EZBACK-N2O	EZBACK-CO2	EZBACK-N2	EZBACK-VAC
<b>E Z Find™ Retrofit Assemblies</b>	EZFIND-OXY	EZFIND-AIR	EZFIND-N2O	EZFIND-CO2	EZFIND-N2	EZFIND-VAC
<b>Service Items</b>						
<b>Retro block</b>	17-0218	17-0218	17-0218	17-0218	17-0218	17-0218
<b>Demand valve</b>	17-0100	17-0101	17-0102	17-0104	17-0103	17-0105
<b>Gauge</b>	14-1019	14-1019	14-1019	14-1019	14-1020	14-1021
<b>1/8 npt bottom port</b>	0 – 100 psig	0 – 100 psig	0 – 100 psig	0 – 100 psig	0 – 300 psig	0 – 30” Hg
<b>1/8 npt Plug</b>	17-0078	17-0078	17-0078	17-0078	17-0078	17-0078
<b>Gas tight cap &amp; chain</b>	GC8224	GC8200	GC8200	GC8200	GC8200	GC8200

Tri-Tech Medical Inc., 35401 Avon Commerce Pkwy., Avon, Ohio 44011

Tel. 1-800-253-8692 -or- 440-937-6244 Fax. 440-937-5060

Web site [www.tri-techmedical.com](http://www.tri-techmedical.com) E mail address: [sales@tri-techmedical.com](mailto:sales@tri-techmedical.com)